

## DETAIL & SUBMITTAL SHEET

CEILING  
ONLY

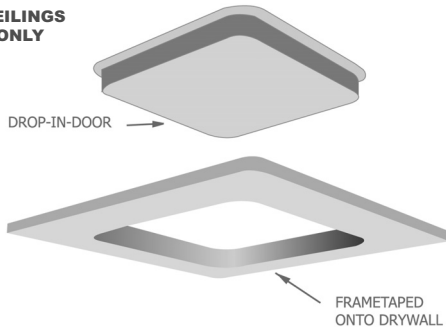

### SPECIFICATIONS:

A state-of-the-art lightweight gypsum based formula that exceeds all required specifications that the market expects.

Manufactured from inorganic material and with 70% post-consumer recycled glass, using a patented composition that consistently provides a superior product. Our gypsum panel is lightweight and features exceptional definition, high compressive strength, and zero mold and fungus growth.

Moisture resistant, no warping, cracking or sagging.

**Door & Frame:** 5/8" lightweight Gypsum, drop in door

**Finish:** Unpainted natural grey Gypsum

**Installation:** Access panels are installed using standard supplies, screws are #6 bugle head. Joints are filled with standard tape and joint compound, then sanded. The access panel has edge thickness to accommodate 5/8" drywall. Therefore, shimming may be required if adjacent material is not 5/8".

Substrate material is determined by job site conditions. The panel does not require framing, but can be connected to adjacent drywall using blocks or studs.

### FRONT ELEVATION

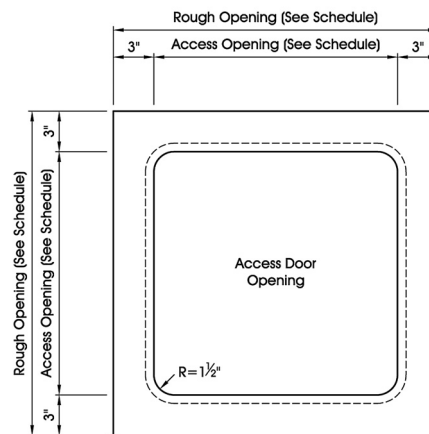

### SECTION DETAIL

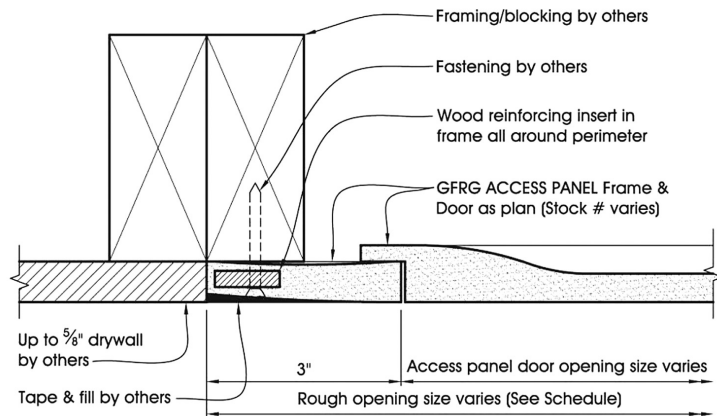

✓	Item No.	Door Opening	Rough Opening	Ship Wt. Lbs.
	GY 3000	12 x 12	18 x 18	5
	GY 3000	18 x 18	24 x 24	10
	GY 3000	24 x 24	30 x 30	15

Project: \_\_\_\_\_ Date: \_\_\_\_\_

Contractor: \_\_\_\_\_ Architect: \_\_\_\_\_

Sizes: \_\_\_\_\_ Quantity: \_\_\_\_\_ Approval Initials: \_\_\_\_\_



Corporate Office: 1330 Progress Drive • Front Royal, VA 22630  
Phone: 1-800-255-5515 • Fax: 1-800-822-5001

[www.wbdoors.com](http://www.wbdoors.com)